

CP935W Base

Yealink HD Touch-Sensitive Wireless Phone System

Yealink CP935W-Base is an HD touch-sensitive cordless phone system designed for small to medium conference rooms. Working with Yealink W70B base station, which owns the DECT radio coverage up to 50 m indoors, CP935W can be provided with a good and stable signal.

Yealink CP935W is a hermit in the conference room. Its black acoustics fabric can realize crystal-clear audio and is resistant to water, oil, and stain. Its ultra-thin body, appropriate desktop fit, and ingeniously hidden wiring slot perfectly fit the simple business style in the conference rooms. Additionally, its built-in Linux system and easy-to-use UI allow users to launch a meeting with one button and increase user adoption.

Yealink CP935W adopts a Y-shaped design and has 6 built-in microphones for sound pickup. Its 20-foot and 360° omni-direction sound pickup gives users a clear and natural voice conference experience.

Thanks to its built-in battery and the DECT technology, CP935W-Base frees you from network and power outlets troubles, giving you a tidy conference table with only one elegant CP935W. Also, its built-in rechargeable battery ensures up to 15 hours of call time and 167 hours of standby time, guaranteeing a long working time without recharging and making CP935W wireless in a DECT environment.

Yealink CP935W supports 5-way conference calls, enabling participants from different locations to communicate smoothly, reducing costs for your company. You can also connect CP935W to your mobile devices (such as smartphones, PCs, etc.) through Bluetooth or USB port to realize Hybrid UC meeting (including SIP, mobile phone, PC).



Key Features and Benefits

- 4-inch multi-touch screen with 480x800 resolution
- Optima HD voice, full duplex technology
- Yealink Noise Proof Technology
- Built-in Bluetooth 4.2
- Built-in Wi-Fi (2.4GHz/5GHz, 802.11a/b/g/n)
- Wi-Fi and DECT mode switchable (Switch via one-touch)

- Built-in battery
- Up to 15-hour talking time (in ideal conditions)
- Up to 167-hour standby time in DECT mode (in ideal conditions)
- 4-hour charging time
- 20-foot (6-meter) and 360-degree microphone pickup range
- Built-in 6-microphone array for voice pickup
- 5-way conference call
- Hybrid UC meeting



4" Multi-Touch Screen



Yealink Pentagon Meeting Room



Built-in Battery



Hybrid UC Meeting



Pairing via Bluetooth







Switching DECT/WIFI

Specifications

Specifications	Description
Audio Features	<ul style="list-style-type: none"> • Optimal HD audio • Yealink Noise Proof Technology • Smart Noise Filtering • 20-foot (6-meter) microphone pickup range • Apply to small to medium conference room • Built-in 6-microphone array, 360-degree voicepickup • Loudspeaker: <ul style="list-style-type: none"> - Frequency: 100-20,000 Hz - Volume: 96 dB at 0.5-m peak volume • 56 mm diameter and 5 w speaker • Full-duplex speakerphone with AEC • Echo cancellation tail length is up to 320 ms • Background noise suppression • Codecs: G722, G722.1C, G726, G.729, G.729A, G723, iLBC, PCMU (G.711μ), PCMA (G.711A), AMR • DTMF: In-band, Out-of-band (RFC 2833) and SIP INFO • VAD, CNG, PLC, AJB, AGC

Phone Features	<ul style="list-style-type: none"> · Up to 10 handsets (CP935W works as a handset) · Up to 10 SIP accounts (only one SIP account on CP935W) · Paging, intercom, dial plan · Call hold, mute, DND, call recording, hotline · 5-way conference call · Switching between calls · Caller ID with name and number · Anonymous call, Anonymous call rejection · Redial, call waiting, emergency call, voice-mail, Keypad lock · Call forward, call transfer, call return · Ring tone selection/import/delete · Set date time manually or automatically · Volume adjustment · Pairing via Bluetooth · Join meeting seamlessly · Active Speaker · Direct IP call without SIP proxy · Reset to factory, reboot
Directory	<ul style="list-style-type: none"> · Local phonebook up to 1000 entries · XML/LDAP remote phonebook · Intelligent search method · Phonebook search/import/export · Call history: all/missed/placed/received/forwarded · Blocklist
IP-PBX features	<ul style="list-style-type: none"> · Busy Lamp Field (BLF) · Multicast paging Intercom · Anonymous call · Anonymous call rejection · Voice mail · Distinctive ringtone · Call pickup
Display	<ul style="list-style-type: none"> · 4" 480x800 capacitive touch screen · Volume key · Home button
Interface	<ul style="list-style-type: none"> · Built-in Wi-Fi · Built-in Bluetooth 4.2 · 1 x USB 2.0 Type-C device port · 1 x Security slot

<p>Network and Security</p>	<ul style="list-style-type: none"> · SIP v1 (RFC2543), v2 (RFC3261) · SNTP/NTP · VLAN (802.1Q and 802.1P) · 802.1x, LLDP · STUN Client (NAT Traversal) · UDP/TCP/TLS · IP assignment: static/DHCP · Support outbound proxy server backup
<p>Management</p>	<ul style="list-style-type: none"> · Configuration: browser/phone/auto-provision · Auto provision via FTP/TFTP/HTTP/HTTPS for mass deploy · Auto-provision with PnP · Zero-sp-touch, TR-069 · Reset to factory, reboot · Package tracing export, system log
<p>Other Physical Features</p>	<ul style="list-style-type: none"> · Color: Black · PSU: 2.2-6 W · Battery capacity: 7800 mAH · Charging time: 4 hours - Up to 167 hours standby time in DECT mode (in ideal conditions) - Up to 15 hours talk time (in ideal conditions) · Dimension (W x D x H): 288.6 mm x 285.2 mm x 63.9 mm · Operating humidity: 10-90% · Storage temperature: -10 to 40°C (+14 to 104°F)
<p>Package Features</p>	<ul style="list-style-type: none"> · Package content: - Yealink CP935W IP conference phone - Charger cradle - W70B Base Station - Base stand - Two Yealink power adapters - Ethernet cable - Quick start guide · Qty/CTN: 5 PCS · N.W/CTN: 7.416 kg · G.W/CTN: 8.420 kg · Giftbox size: 355 mm x 349 mm x 108 mm · Carton meas: 567 mm x 357 mm x 365 mm
<p>Compliance</p>	    

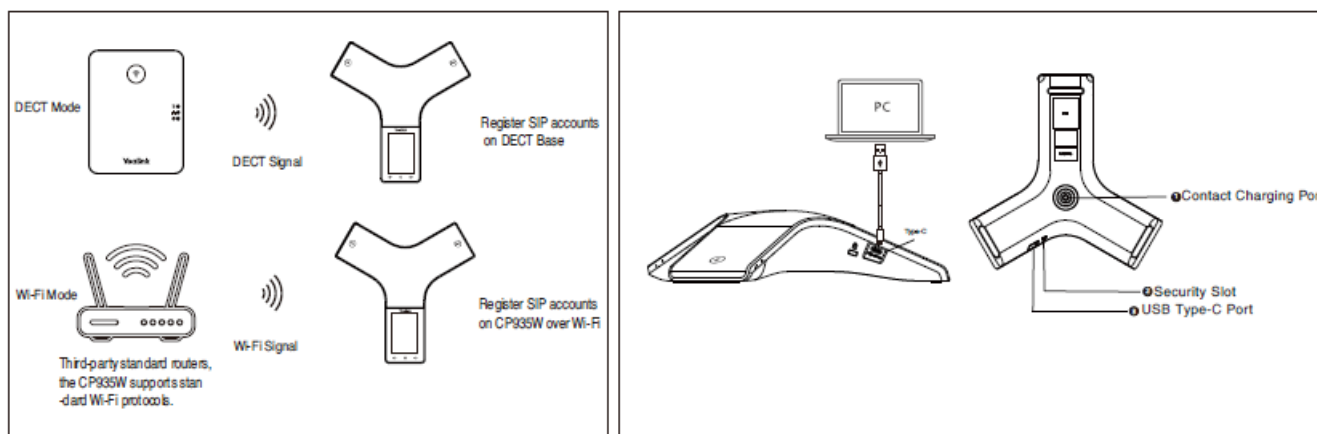

[Click Here](#) to go to the product introduction on the Yealink official website.